

[AI Link set-up guide for H3 Pro – Fox ESS Tech Hub](#)

<https://fox-ess.tech/>



This guide provides a quick-reference, summarised overview of the installation, commissioning and set-up of the AI Link for H3 Pro. It should only be used alongside the full installation manual(s) for the product(s). Please refer to the relevant product manual(s) for full guidance.

1. H3-Pro.

1.1 Wiring from the Chint meter to the AI Link – ports 24/25 on Chint meter DTSU-666 to pins 1 and 2 of the AI link RJ45 – plugged in the meter port on the AI Link.

	AI Link	Meter (CHINT DTSU666)
RS485 A	Pin 2 (Meter/485, RS485-A1)	Pin 24
RS485 B	Pin 1 (Meter/485, RS485-B1)	Pin 25

1.2 Wiring from AI link to the inverter RJ45 plug (pins 1-8) from the inverter port of the AI Link to the comms plug of the master H3-PRO Port 1.

1.3 Port 2 of the H3-Pro comms plug to the slave inverter.

1.4 Dip switches on the comms plug MUST be switched to on, on the last slave inverter.

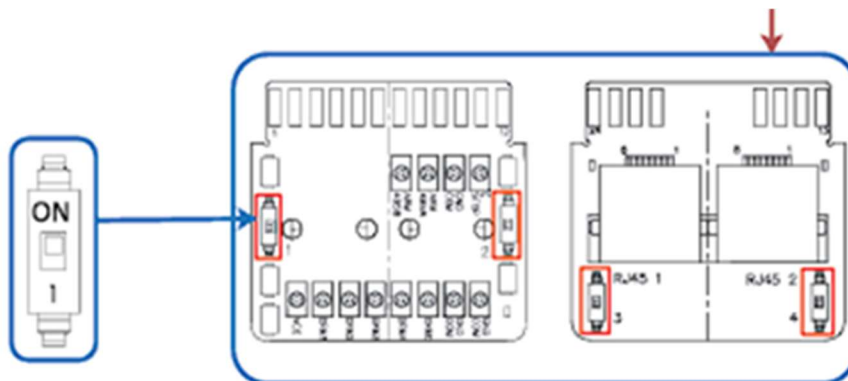

Note: You MUST make sure that ALL inverters are upgraded to (as of 3/7/2025)

- Master 1.58
- Slave 1.06
- Manager 1.34

You will also need to make sure the AI Link is on the latest firmware – **EMS V2.015**

2. Commissioning

2.1 Connecting AI Link to the internet:

To connect to AI Link to the internet first you need to create a plant. Assign the AI Link to the plant.

Before connecting the AI Link to the internet, you will need to press the start button on the AI Link,

The comms light will start flashing.

- Click on ME at the bottom of the app.
- Click on WLAN configuration.
- Tick the EMS serial number.
- Click start on the AI Link until the comms light flashes.
- Click connect network on the app.
- Input the SSID and password of the end user's WIFI.
- Click next.

The AI Link will now try and pair it to the internet. Once connection has been completed the App/AI Link will automatically go into a configuration process to allocate any meter's or inverters correctly installed and wired to the AI Link. This process takes about 30 seconds.

- Once fully configured you will see the number of meters and inverters wired to the AI Link. For example 1 meter and 2 inverter's.
- You will be prompted to select the AC wiring setup, No EPS, Parallel with EPS. Select the relevant setup.
- Click Finish.

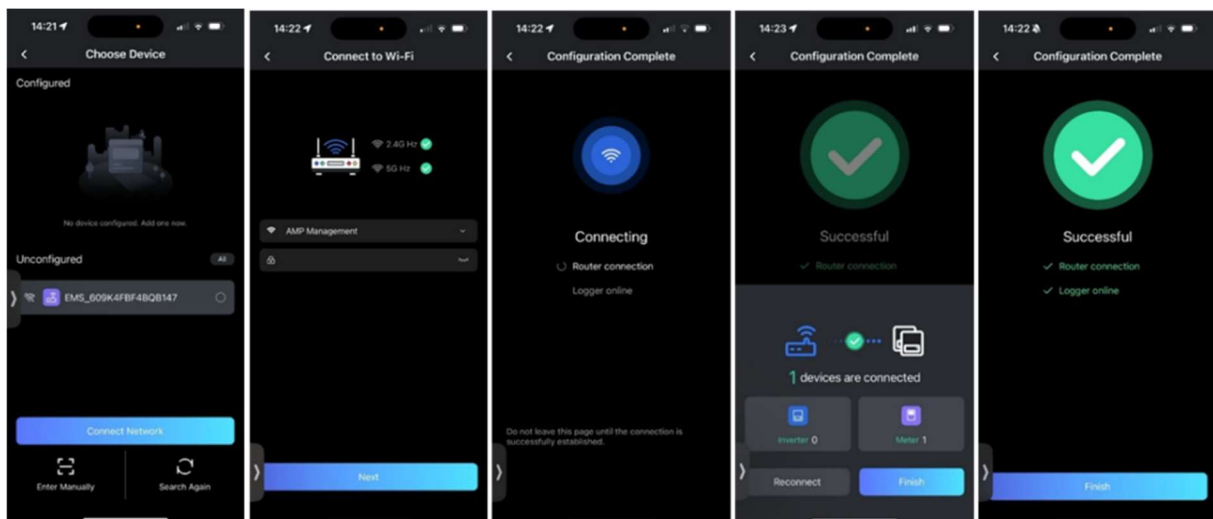

After all the above steps have been completed. The AI Link will now be fully commissioned. You will then be able to see the Meter(s) and inverters on the app and cloud.

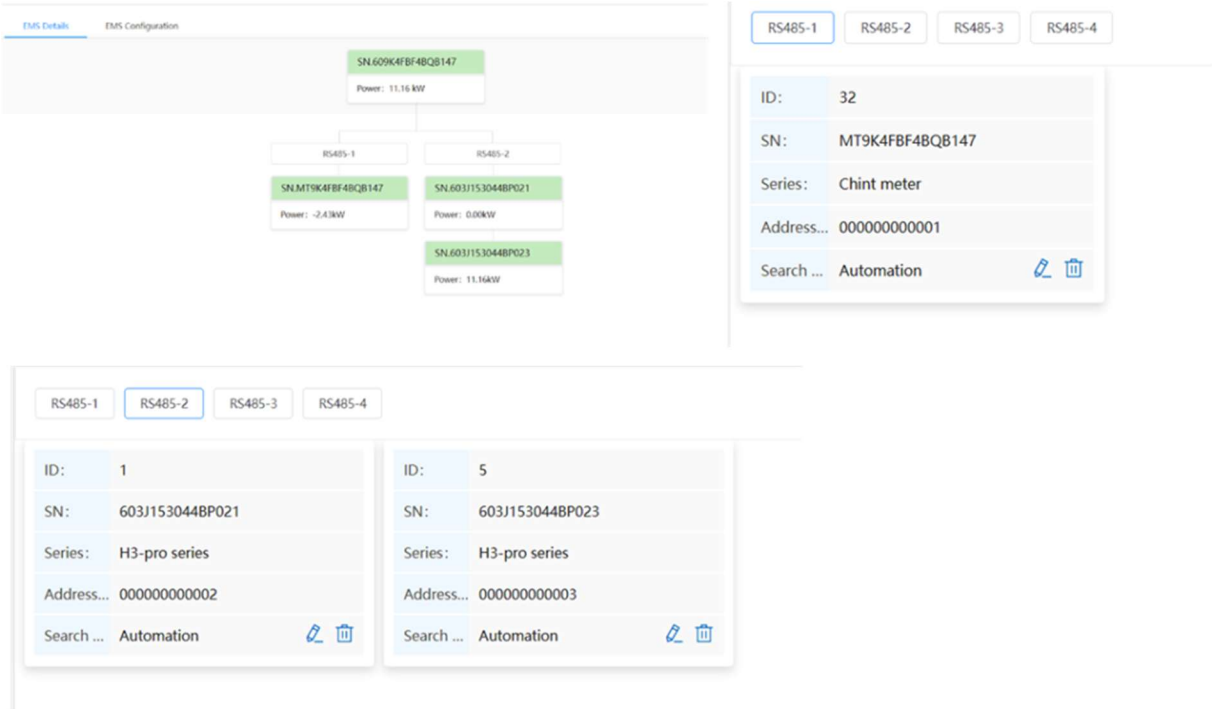

The AI Link should display the following lights:

Power – Solid green

Comm – Solid green

Cloud – Solid green



Important information

- There is no need to manually input the inverter serial numbers on the cloud. This will be auto populated once the above steps are completed.
- The RS485 Communication on the inverter will also auto populate ID 1 and ID 2 do not need to be touched.

Master inverter ID1 & ID2 are auto set to 3



Slave inverter ID1 & ID2 are auto set to 2



- Meter 1 on both inverters MUST be disabled.
- If the comms light does not flash on the AI link when you are trying to pair, check the comms cable between the AI Link and the inverters.

- If you cannot find the inverters after repairing via the app check comms cables and dip switches on the inverters.

Connecting a 3rd party inverter

compatible Fox inverters for 3rd party monitoring:

- R Series
- V Series

You will require another chint DTSU-666 CT meter to read the 3rd party meter.

	AI Link	Meter (CHINT DTSU666) PV
RS485 A	Pin 6 (Meter/485, RS485-A3)	Pin 24
RS485 B	Pin 3 (Meter/485, RS485-B3)	Pin 25

if you need to configure the 3rd party PV generation on the EMS cloud, you will need to define the meter serial number, this cannot be the same serial number as the grid meter.

this is set on the config page under RS485-3, set the inverter model to 3rd party generation.

set the address to 1

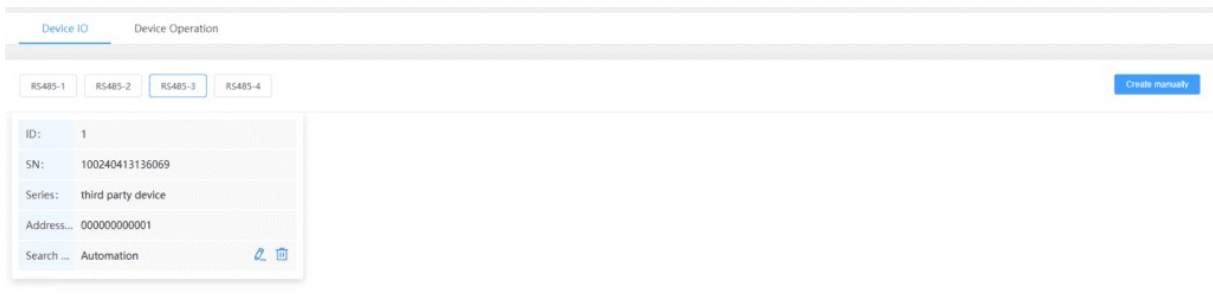

the address on the chint meter stays the same ADD 1